

1-COMplete FRAME ASSEMBLY

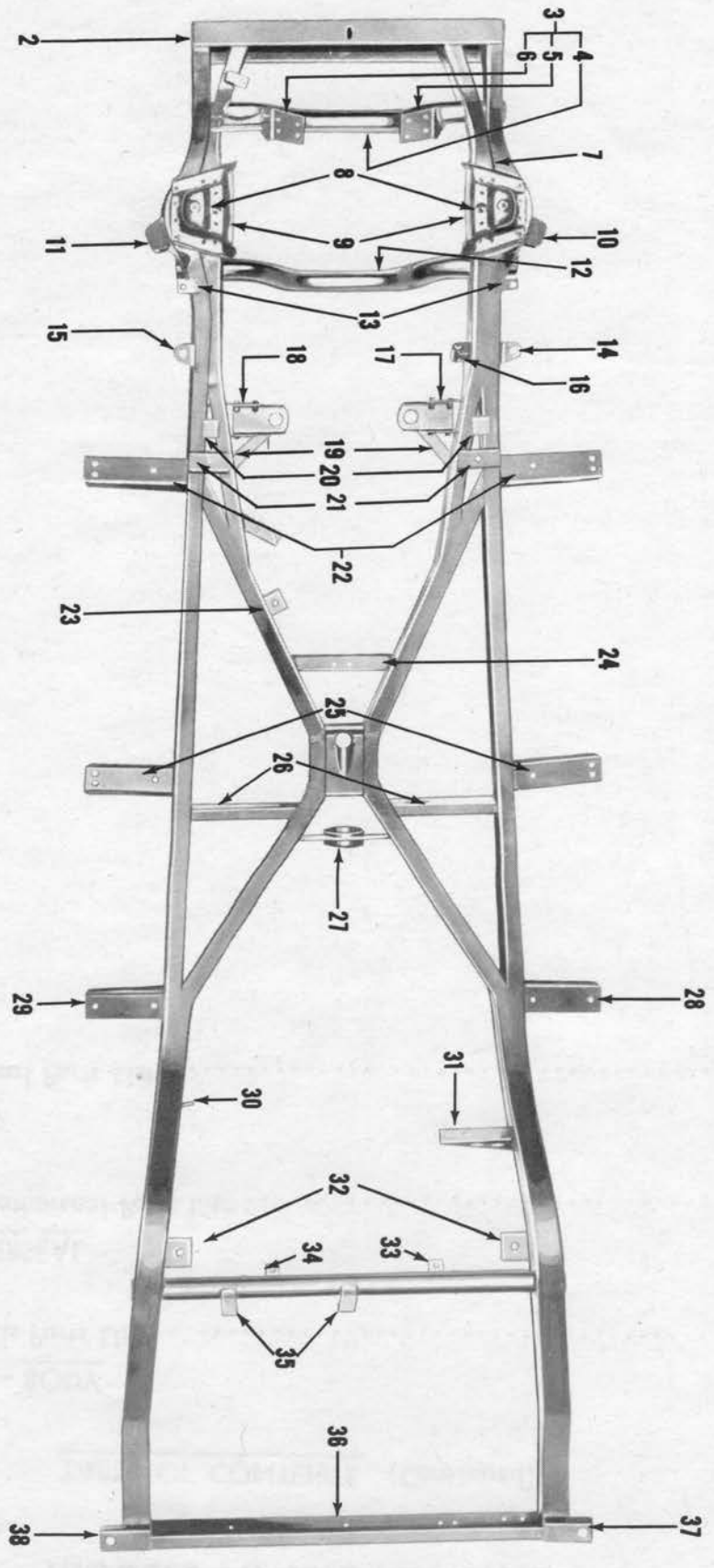

FRAME ASSEMBLY  
ILLUSTRATION NO. 1

# CHECKER MOTORS CORPORATION—PARTS CATALOG

## MODELS A9 A9L A10 A10L

FRAME		GROUP 1		
Illus. Key	Part No.	Description	Qty. Req'd.	Model
<u>FRAME ASSEMBLY</u>				
1-1	95085	FRAME ASSEMBLY - Chassis Complete	1	All
1-2	94189	CROSSMEMBER - Front	1	"
1-3	92382	CROSSMEMBER ASSEMBLY - Front Suspension Front	1	"
1-4	N. S. S.	CROSSMEMBER - Front Suspension Front	1	"
1-5	92259	BRACKET - Front Engine Mounting R.H.	1	"
1-6	92260	BRACKET - Front Engine Mounting L.H.	1	"
1-7	95060	BRACKET ASSEMBLY - Battery Support	1	"
1-8	94525	BRACKET - Upper Control Arm to Frame R.H. & L.H.	2	"
	142783	RIVET - Upper Control Arm to Frame (5/16 x 3/4 Rd. Hd.)	12	"
1-9	92243	SEAT - Front Spring	2	"
	117557	RIVET - Front Spring Seat to Frame (5/16 x 1 Fl. Hd.)	4	"
	141471	RIVET - Front Spring Seat to Frame (5/16 x 1 Fl. Hd.)	4	"
1-10	92274	BRACKET - Front Suspension Frame Bumper R.H.	1	"
1-11	92275	BRACKET - Front Suspension Frame Bumper L.H.	1	"
1-12	92383	CROSSMEMBER ASSEMBLY - Front Suspension Rear	2	"
1-13	92639	BRACKET - Front Brake Hose	1	"
1-14	94306	BRACKET - Dash Support R.H.	1	"
1-15	94305	BRACKET - Dash Support L.H.	1	"
1-16	92395	BRACKET ASSEMBLY - Steering Idler Arm	1	"
1-17	94112	BRACKET - Rear Engine Support R.H.	1	"
1-18	94111	BRACKET - Rear Engine Support L.H.	1	"
1-19	94542	GUSSET - Rear Engine Support Bracket	2	"
1-20	94335	PLATE - Rail Tie Upper and Lower	4	"
1-21	92254	BRACKET - Body Frame Inner	2	"
1-22	94194	BRACKET - Body Frame Front	2	"
1-23	94346	BRACKET - Parking Brake Cable	1	"
1-24	94345	BRACKET - Parking Brake Lever	1	"
1-25	94195	BRACKET - Body Frame Center	2	"
1-26	94518	BRACE - Side Rail to Crossmember	2	"
1-27	95125	SUPPORT ASSEMBLY - Midship Bearing	1	"
1-28	93864	BRACKET ASSEMBLY - Body Frame Rear R.H.	1	"
1-29	93863	BRACKET ASSEMBLY - Body Frame Rear L.H.	1	"
1-30	92502	BRACKET - Rear Brake Hose	1	"
1-31	94296	SUPPORT - Muffler	1	"
1-32	94171	BRACKET - Body Frame to Kick Up	2	"
1-33	93866	BRACKET ASSEMBLY - Shock Absorber Mounting R.H.	1	"
1-34	93865	BRACKET ASSEMBLY - Shock Absorber Mounting L.H.	1	"
1-35	92170	BRACKET - Fuel Tank Support	2	"
1-36	93870	CROSSMEMBER ASSEMBLY - Rear	1	"
1-37	94520	BRACKET - Frame Rear Corner to Body R.H.	1	"
1-38	94519	BRACKET - Frame Rear Corner to Body L.H.	1	"
	94589	BRACKET - Engine Support Frame L.H.	1	"
	94590	BRACKET - Engine Support Frame R.H.	1	"

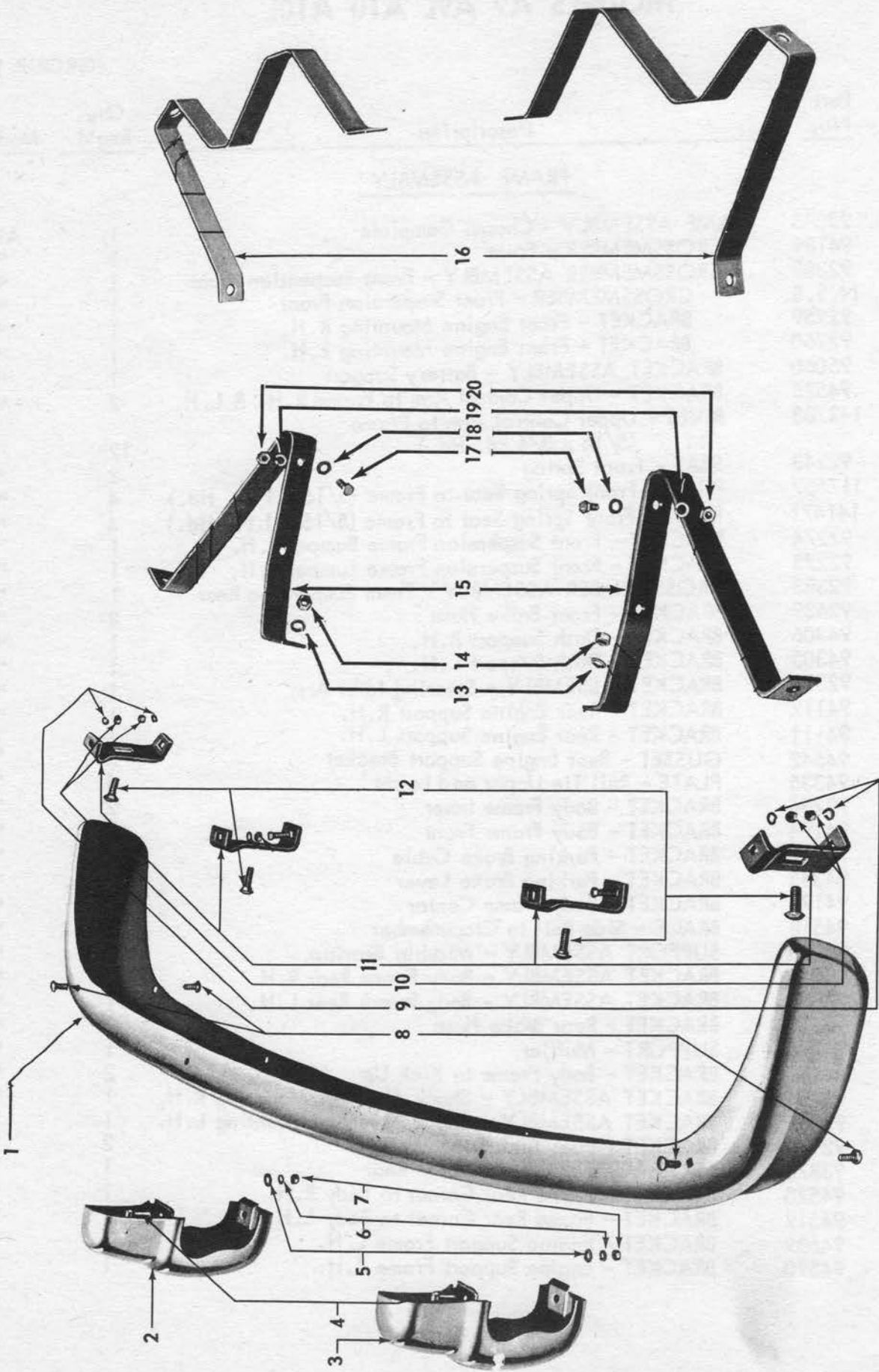

FRONT AND REAR BUMPER ASSEMBLY  
ILLUSTRATION NO. 2

# CHECKER MOTORS CORPORATION—PARTS CATALOG

## MODELS A9 A9L A10 A10L

FRAME			GROUP 1	
Illus. Key	Part No.	Description	Qty. Req'd.	Model
<u>FRONT AND REAR BUMPER ASSEMBLY</u>				
2-1	92529	BAR - Front and Rear Bumper Face	2	ALL
2-2	92592	GUARD ASSEMBLY - Front R.H. and Rear L.H. Bumper Bar	2	"
2-3	92593	GUARD ASSEMBLY - Front L.H. and Rear R.H. Bumper Bar	2	"
2-4	121615	BOLT - Bumper Bar and Guard to Support Bracket (3/8 - 24 x 1-1/4 Hex Hd.)	8	"
2-5	178566	LOCKWASHER - Bumper Bar and Guard to Support Bracket (3/8 Int. Ext.)	4	"
2-6	120382	LOCKWASHER - Bumper Bar and Guard to Support Bracket (3/8)	4	"
2-7	120369	NUT - Bumper Bar and Guard to Support Bracket (3/8 - 24 Hex)	8	"
2-8	121807	BOLT - Bumper Bar to Support Bracket Chrome (3/8 - 16 x 1 Rd. Hd.)	8	"
2-9	120382	LOCKWASHER - Bumper Bar to Support Bracket (3/8)	8	"
2-10	120377	NUT - Bumper Bar to Support Bracket (3/8-16 Hex)	8	"
2-11	92530	BRACKET - Front and Rear Bumper Bar Support	8	"
2-12	120917	BOLT - Bumper Support Bracket to Bumper Support (1/2 - 13 x 1-1/2 Rd. Hd.)	8	"
	120396	PLAINWASHER - Bumper Support Bracket to Bumper Support (17/32 I.D. x 1-1/16 O.D.)	8	"
2-13	120384	LOCKWASHER - Bumper Support Bracket to Bumper Support (1/2)	8	"
2-14	120378	NUT - Bumper Support Bracket to Bumper Support (1/2 - 13 Hex)	8	"
2-15	94314	SUPPORT - Front Bumper to Frame	2	"
	125814	BOLT - Front Support to Frame (1/2 - 20 x 4-1/2 Hex Hd.)	2	"
2-16	94307	SUPPORT - Rear Bumper to Frame	2	"
2-17	123611	BOLT - Bumper Support to Frame (1/2 - 20 x 1-1/8 Hex Hd.)	10	"
2-18	120396	PLAINWASHER - Bumper Support to Frame (17/32 I.D. x 1-1/16 O.D.)	12	"
2-19	120384	LOCKWASHER - Bumper Support to Frame (1/2)	12	"
2-20	120371	NUT - Bumper Support to Frame (1/2 - 20 Hex)	8	"

