

## EXHAUST SYSTEM

## SECTION I. REMOVAL AND INSTALLATION

## 1-1. Removal.

a. Remove tail pipe bracket nut (1-33), lockwasher (1-32), and insulator (1-31). Remove bracket (1-27), insulator (1-31), bolt (1-28), spacer (1-30), and washer (1-29).

## NOTE

A-12W tail pipe bracket is attached to frame side member support. All other models have brackets on rear crossmember.

b. Loosen muffler to tail pipe clamp assembly (1-16). Support muffler (1-15) and remove tail pipe (1-24).

c. Remove muffler support bracket nuts (1-23), lockwashers (1-22), and insulators (1-21). Remove bracket (1-17) with spacers (1-20), washers (1-19), and bolts (1-18).

d. Support extension pipe (1-13). Loosen extension pipe to muffler clamp assembly (1-14). Remove muffler (1-15).

e. Loosen exhaust pipe to frame clamp assembly (1-11) and remove extension pipe (1-13).

f. Support front pipe (1-2). Remove frame support nuts (1-10), lockwashers (1-9), and insulators (1-6). Remove frame support (1-12) with spacers (1-7), insulator washers (1-8), and bolts (1-5).

g. Disconnect front pipe flange at engine exhaust manifold. Remove front pipe (1-2) and gasket (1-1).

h. Inspect all parts for damage. Replace badly dented or corroded pipes. Replace muffler if defective or badly corroded. Replace front pipe gasket.

## 1-2. Installation.

a. Support rear end of front pipe (1-2). Place gasket (1-1) on front pipe flange and install pipe at exhaust manifold. Torque nuts to 25-30 foot-pounds.

b. Slide frame support clamp over front pipe. Install frame support (1-12) with bolts (1-5), insulators (1-6), spacers (1-7), insulator washers (1-8), lockwashers (1-9), and nuts (1-10). Torque nuts to 5-8 foot-pounds.

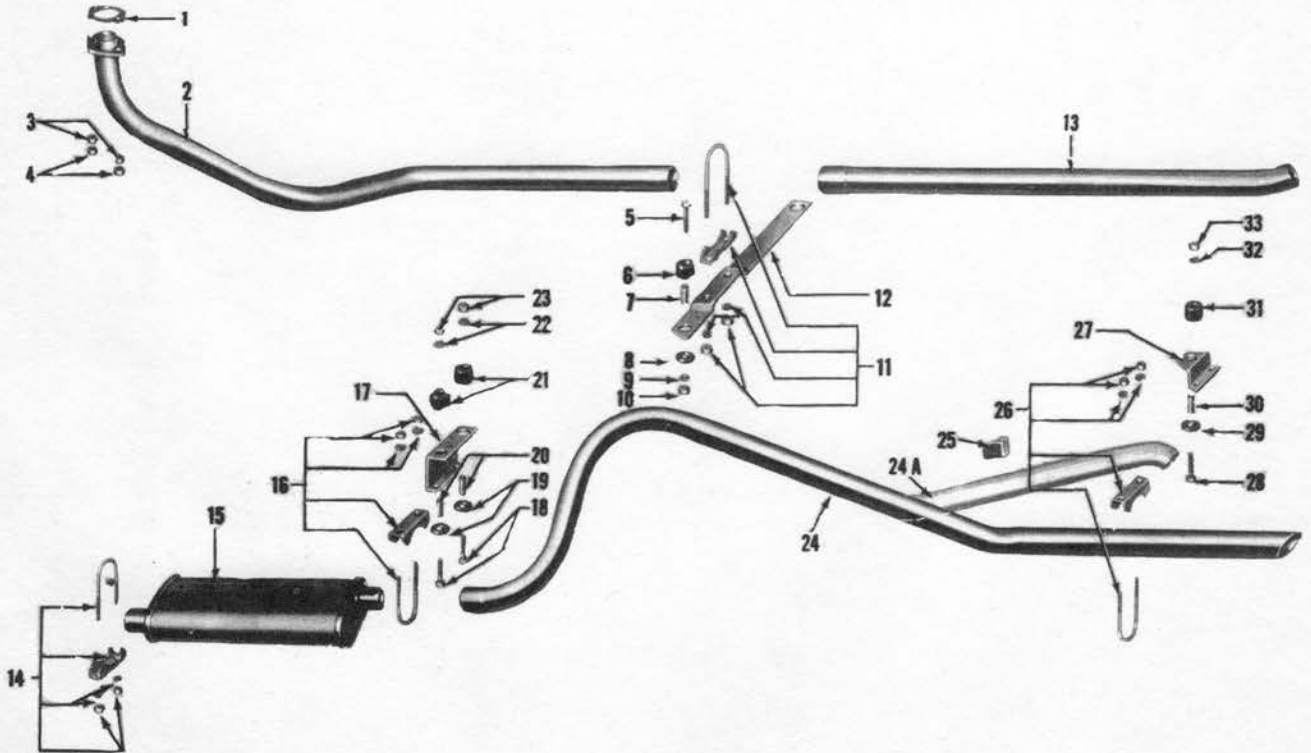

Fig. 1 - Exhaust System

Group 15 - Exhaust System

c. Slide extension pipe (1-13) through clamp, over front pipe (1-2). Support rear end of extension pipe and tighten frame support clamp assembly (1-11). Torque nuts to 5-8 foot-pounds.

d. Slide extension pipe clamp assembly (1-14) over front flange of muffler (1-15). Slide muffler flange over extension pipe, just enough to close slots in flange.

e. Slip muffler to tail pipe clamp over rear flange of muffler. Install muffler support bracket assembly (1-17 through 23). Torque nuts to 5-8 foot-pounds.

f. Support rear end of tail pipe (1-24). Slip front of tail pipe over rear muffler flange.

g. Slide rear clamp assembly (1-26) on tail pipe. Install tail pipe bracket (1-27). Torque nuts to 5-8 foot-pounds.

h. Check tail pipe clearance as follows:

(1) At 3" distance in front of tubular frame crossmember, clearance between tail pipe and side frame member should be 1/4" to 1/2".

(2) Vertical distance between tail pipe and tubular crossmember should be at least 1/2".

i. Tighten front and rear muffler clamp nuts (1-14, 16). Torque to 5-8 foot-pounds.

